

400 MAPLE STREET (HWY 11)

COMMERCE :: TX 75428

AVAILABLE



FEATURES:

TOTAL BUILDING SF: ± 309,454 SF

MFG/WHSE SF : ± 289,454 SF

OFFICE SPACE: ± 10,000 SF

LAND: ±47.0 Acres

YEAR BUILT: 1974 to 2003

COLUMN SPACING: 25' x 40'

CEILING HEIGHT: 13'-25'-8"

CAR PARKING: 400 spots

A/C: 100%

SPRINKLER: 100% Wet

POWER: Abundant

LOADING: 10 truck dock positions
3 drive-in doors

COMMENTS:

- Seven (7) rail car positions: Blacklands Railroad (BLR) is short-line carrier
- Eight (8) silos
- < 10 miles from I-30; ±66 miles northeast of Dallas



FOR MORE INFORMATION CONTACT

Steven H. Berger, SIOR

214.979.6333

steve.berger@cbre.com

Chuck Finney, SIOR

214.979.6325

chuck.finney@cbre.com

CBRE

400 MAPLE STREET (HWY 11)

COMMERCE :: TX 75428

AVAILABLE



FLOOR PLAN

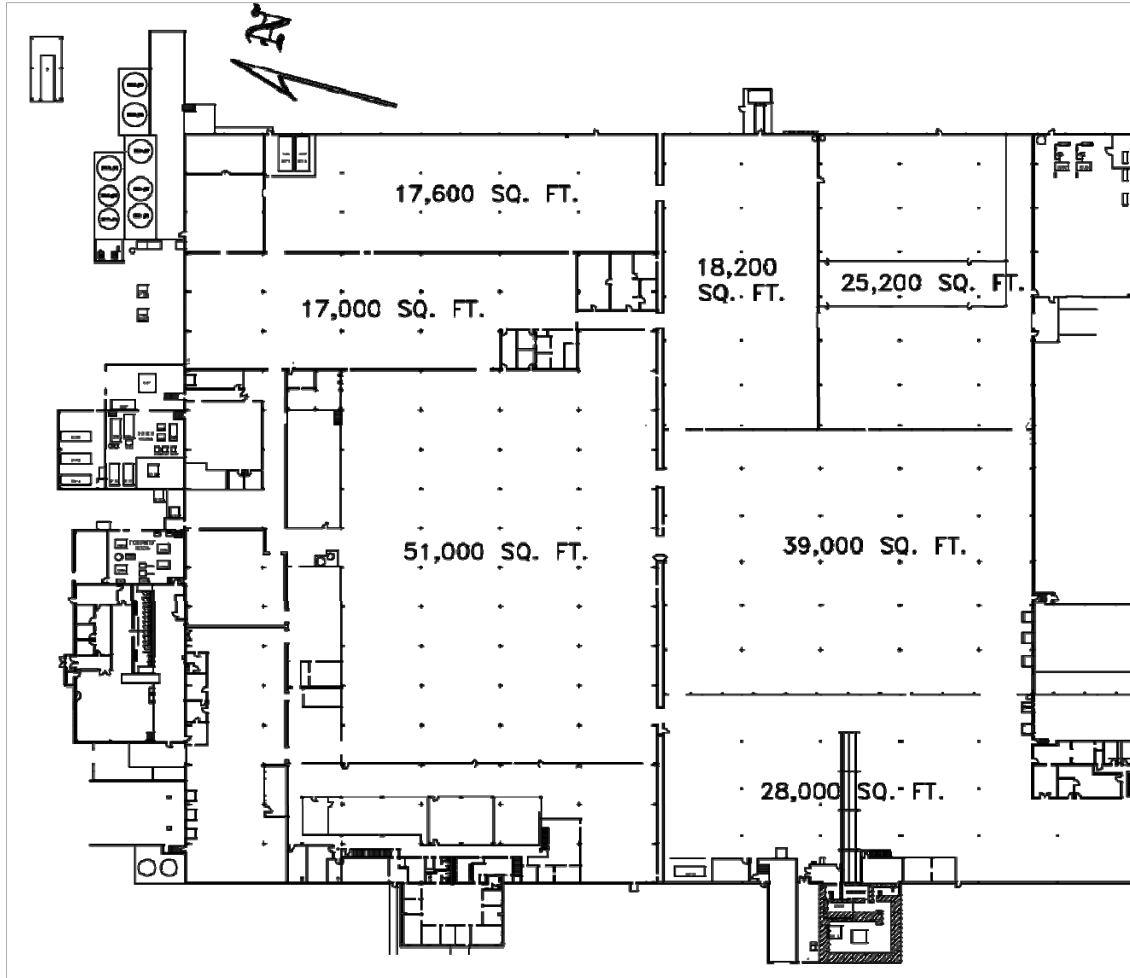

SITE PLAN

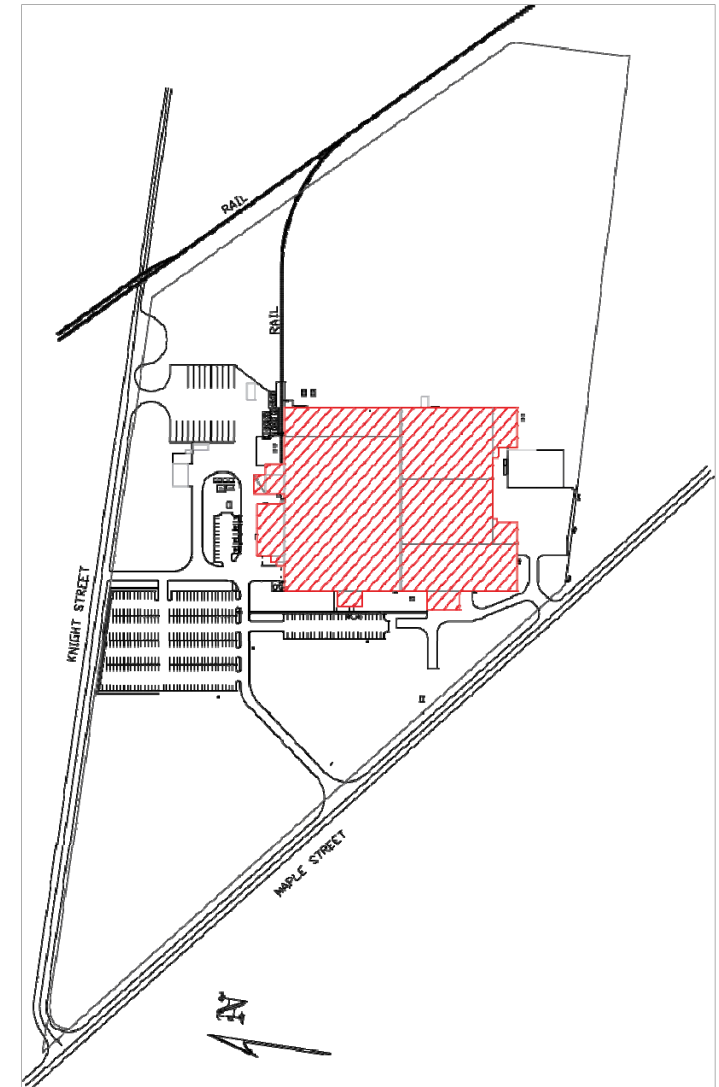

CBRE | 2100 McKinney Avenue, Suite 700 | Dallas, TX 75201 | www.cbre.com
Licensed Real Estate Broker

© 2013 CBRE, Inc. This information has been obtained from sources believed reliable. We have not verified it and make no guarantee, warranty or representation about it. Any projections, opinions, assumptions or estimates used are for example only and do not represent the current or future performance of the property. You and your advisors should conduct a careful, independent investigation of the property to determine to your satisfaction the suitability of the property for your needs.

